

RECYCLING COLLECTION SCHEDULE

July 2020 - June 2021

Place paper, container and glass (December 2020) recycling at curb by



7:00 am

JULY 2020							AUGUST 2020							SEPTEMBER 2020							OCTOBER 2020						
SUN	MON	TUE	WED	THU	FRI	SAT	SUN	MON	TUE	WED	THU	FRI	SAT	SUN	MON	TUE	WED	THU	FRI	SAT	SUN	MON	TUE	WED	THU	FRI	SAT
			1	2	3	4							1			1	2	3	4	5			1	2	3		
5	6	7	8	9	10	11	2	3	4	5	6	7	8	6	7	8	9	10	11	12	4	5	6	7	8	9	10
12	13	14	15	16	17	18	9	10	11	12	13	14	15	13	14	15	16	17	18	19	11	12	13	14	15	16	17
19	20	21	22	23	24	25	16	17	18	19	20	21	22	20	21	22	23	24	25	26	18	19	20	21	22	23	24
26	27	28	29	30	31		23	24	25	26	27	28	29	27	28	29	30				25	26	27	28	29	30	31

NOVEMBER 2020							DECEMBER 2020							JANUARY 2021							FEBRUARY 2021						
SUN	MON	TUE	WED	THU	FRI	SAT	SUN	MON	TUE	WED	THU	FRI	SAT	SUN	MON	TUE	WED	THU	FRI	SAT	SUN	MON	TUE	WED	THU	FRI	SAT
1	2	3	4	5	6	7			1	2	3	4	5						1	2		1	2	3	4	5	6
8	9	10	11	12	13	14	6	7	8	9	10	11	12	3	4	5	6	7	8	9	7	8	9	10	11	12	13
15	16	17	18	19	20	21	13	14	15	16	17	18	19	10	11	12	13	14	15	16	14	15	16	17	18	19	20
22	23	24	25	26	27	28	20	21	22	23	24	25	26	17	18	19	20	21	22	23	21	22	23	24	25	26	27
29	30						27	28	29	30	31			24	25	26	27	28	29	30	28						

MARCH 2021							APRIL 2021							MAY 2021							JUNE 2021						
SUN	MON	TUE	WED	THU	FRI	SAT	SUN	MON	TUE	WED	THU	FRI	SAT	SUN	MON	TUE	WED	THU	FRI	SAT	SUN	MON	TUE	WED	THU	FRI	SAT
	1	2	3	4	5	6					1	2	3			1	2	3	4	5			1	2	3	4	5
7	8	9	10	11	12	13	4	5	6	7	8	9	10	2	3	4	5	6	7	8	6	7	8	9	10	11	12
14	15	16	17	18	19	20	11	12	13	14	15	16	17	9	10	11	12	13	14	15	13	14	15	16	17	18	19
21	22	23	24	25	26	27	18	19	20	21	22	23	24	16	17	18	19	20	21	22	20	21	22	23	24	25	26
28	29	30	31				25	26	27	28	29	30		23	24	25	26	27	28	29	27	28	29	30			

ENSURE MORE MATERIALS ARE RECYCLED AND KEPT OUT OF LANDFILL BY REMEMBERING THESE PRO-TIPS:

- 1 Line it up.** Put your recycling boxes beside each other. Keep 1m (3ft) between your recycling containers and your garbage/green bin.
- 2 Keep it clean.** Empty and rinse all containers.
- 3 Flatten and cut.** If your cardboard is too large for your blue box or yellow bag, flatten and cut it down to smaller pieces. 30" x 30" (76cm x 76cm) or smaller. Stack them between recycling containers. Remember to keep plastic wrap out of your recycling!
- 4 Connect with us.** Download our app, email us at info@recyclebc.ca, or connect with us on social media @RecycleBC.

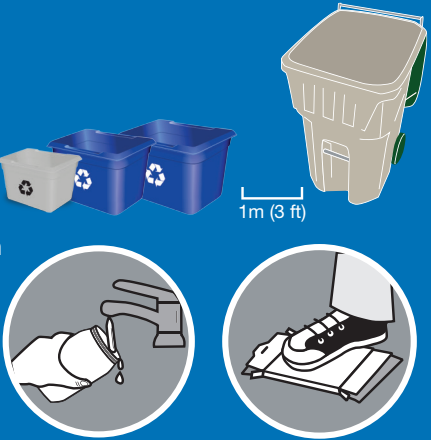

NEW FOR 2020-2021!

NEW GLASS COLLECTION



RECYCLEBC™

Making a difference together.



RECYCLING COLLECTION QUESTIONS?

Emterra is Recycle BC's curbside collection partner in the Regional District of North Okanagan. They can answer questions about collection zones, missed pick-ups, holiday schedules, or recycling containers.

Contact: Emterra
Phone: 250-545-4245
Email: askmebc2@emterra.ca

NEARBY DEPOTS

Armstrong Bottle Depot
3730 Pleasant Valley Blvd, Armstrong
250-546-2466

Interior Freight And Bottle Depot
4205 24 Avenue, Vernon
250-545-5706

London Drugs - Vernon Square Mall
4400 32 St, Vernon BC V1T 9G8
250-549-1551

Venture Bottle Depot
1818 Miller Street, Lumby
250-547-8787

Venture Training Centre
4240 Alexis Park Drive, Vernon
250-542-2374

*London Drugs accepts plastic bags and overwrap, foam packaging, and other flexible plastic packaging only. Due to space limitations, a maximum of one grocery bag of each material is suggested per visit.

ABOUT RECYCLE BC

Recycle BC is a not-for-profit organization responsible for residential packaging and paper recycling throughout BC, servicing over 1.8 million households. Recycle BC ensures your household materials are picked up, sorted, and responsibly recycled. Our program is funded by over 1,200 businesses that include retailers, manufacturers and restaurants that supply packaging and paper to BC residents, shifting costs away from homeowners.

For more information visit:

RecycleBC.ca
@RecycleBC



Recycling Collection Questions?

Emterra is Recycle BC's curbside collection partner in the Regional District of North Okanagan. They can answer questions about collection zones, missed pick-ups, holiday schedules, or recycling containers.

Contact Emterra
Phone: 250-545-4245
Email: askmebc2@emterra.ca

For information about garbage, compost, or yard and garden waste services, please contact your local government.

Please find a detailed material list at [RecycleBC.ca/what-can-i-recycle](https://www.recyclebc.ca/what-can-i-recycle).
請瀏覽 [RecycleBC.ca/what-can-i-recycle](https://www.recyclebc.ca/what-can-i-recycle) 查詢物料清單中文版。
ਕਿਰਪਾ ਕਰਕੇ ਇਕ ਅਨੁਵਾਦਿਤ ਸਮੱਗਰੀ ਸੂਚੀ ਨੂੰ ਇਥੇ ਦੇਖੋ [RecycleBC.ca/what-can-i-recycle](https://www.recyclebc.ca/what-can-i-recycle).
번역 된 자료 목록은 [RecycleBC.ca/what-can-i-recycle](https://www.recyclebc.ca/what-can-i-recycle) 에서 찾으십시오.

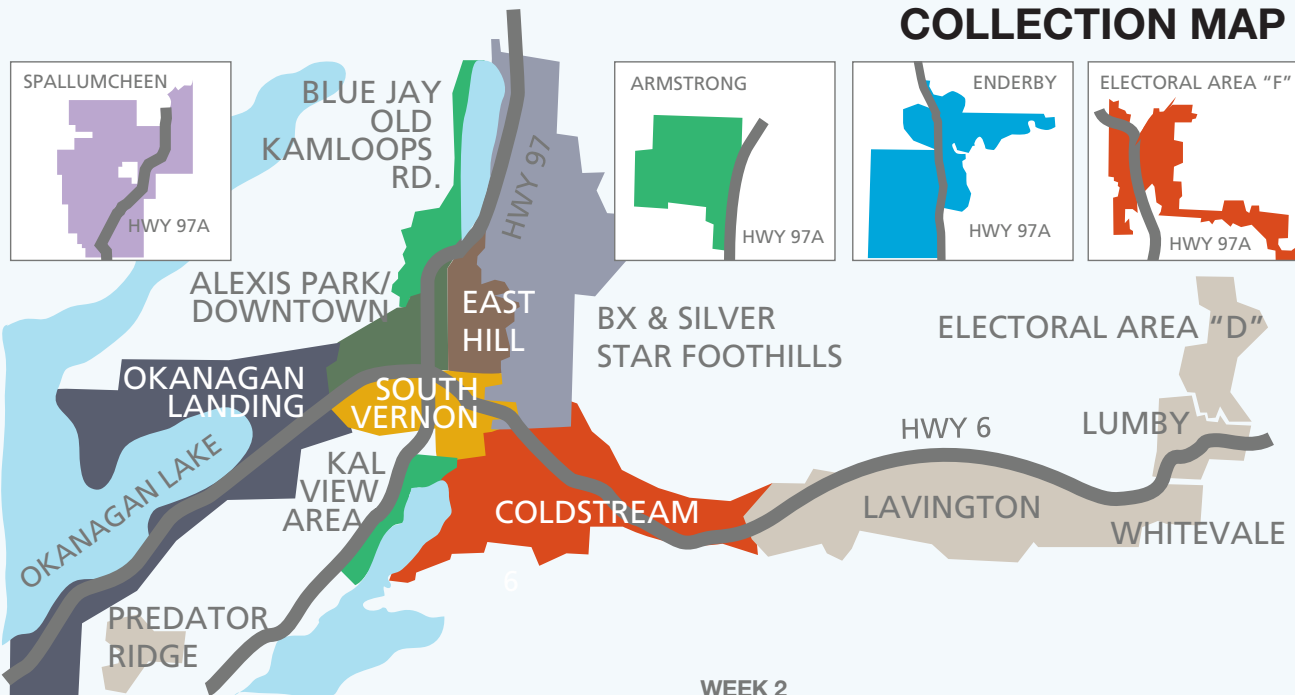

- WEEK 1**
- MONDAY:** Spallumcheen
 - TUESDAY:** East Hill Area
North of 25th Ave & East of 27th St. including Shantz and Mutrie Rds, Harwood & Heron areas. (Does NOT include Silver Star Foothills)
 - WEDNESDAY:** Alexis Park/Downtown Area
North of 25th Ave from 27th St. to Allenby, Richfield and Heritage up to 5900; including Downtown, Alexis Park, Turtle Mountain, Bella Vista, Allenby
 - THURSDAY:** South Vernon Area
South of 25th Ave within the City of Vernon including Mission Hill up to Fulton Rd, Polson/VSS areas, Middleton Mtn area up to the Coldstream boundary. (Does NOT include Country Estates).
 - FRIDAY:** Okanagan Landing Area
West of Fulton & Allenby including Tronson Rd, Eastside Rd, Ellison Park, The Rise and Heritage 5900+

- WEEK 2**
- MONDAY:** City of Enderby, Splitsin First Nation IR Enderby 2
 - TUESDAY:** Predator Ridge, Lavington, Lumby & Electoral Area "D"
East of Brewer Rd and Warren Rd, Whitevale, Village of Lumby, and North of Lumby up to Trinity Valley Rd
 - WEDNESDAY:** Old Kamloops Rd, Blue Jay Area, Kal View Area & Armstrong
Includes Country Estates, Kalamalka Slopes, Guildford Court, Kal Lakeview, Kickville/Westkal Rd and up Kal Lake Road to #17609, and Armstrong.
 - THURSDAY:** Parts of Coldstream & Electoral Area "F"
Including the Middleton Mtn and Sarsons/Fenwick areas south of Hwy 6, and Coldstream Valley Estates (Does NOT include Kickville/Westkal Rd), and parts of Electoral Area "F"
 - FRIDAY:** BX & Silver Star Foothills
From the Spallumcheen boundary to the Coldstream boundary. (Does NOT include Sarsons/Fenwick area south of Hwy 6).



RecycleBC.ca

PAPER

PUT INTO YELLOW BAG
OR ONE BLUE BOX

Recycle at curbside or depot
Clean and dry paper only



CONTAINERS

PUT INTO OTHER
BLUE BOX

Recycle at curbside or depot
Empty and rinse containers



GLASS

PUT INTO GREY BOX

Take glass to a depot until your
grey glass box arrives



Coming December 2020

DROP-OFF ONLY

TAKE TO RECYCLING DEPOT

Not accepted in your yellow bag,
blue boxes or grey box



Newspapers, inserts, flyers

Magazines, catalogues, phone books

Boxboard boxes

Moulded paper

Household paper

Envelopes

Paper bags

Shredded paper (contain in paper bag or box first)

Cardboard boxes

- ✓ Greeting cards
- ✓ Paper gift wrap
- ✓ Paper gift bags
- ✓ Paper carry-out beverage trays
- ✓ Cores from paper towel and toilet paper

Plastic bottles, jars and jugs

Plastic trays and clamshells

Plastic garden pots and seedling trays

Caps, tops, lids and pumps

Plastic or paper take-out cups, bowls and lids

Cartons for soup, milk, etc.

Metal cans

Aerosol cans (empty)

Foil wrap and take out containers

- ✓ Plastic packaging for toys, batteries etc. Separate plastic from paper backing
- ✓ Plastic pails less than 25L for laundry detergent, cat litter, etc.
- ✓ Spiral wound cans and lids for frozen juice concentrate, chips, etc.
- ✓ Plastic tubs for yogurt, margarine, etc.

Glass bottles - clear and coloured

Glass jars - clear and coloured

Put all lids in blue box.

NOT ACCEPTED
Do NOT place into Grey Box

- ✗ Drinking glasses, dishes, cookware
- ✗ Window glass, mirrors
- ✗ Ceramic products
- ✗ Light bulbs or light fixtures

Want to recycle something not included here?

Search Recycle BC's Waste Wizard or download a full material list at RecycleBC.ca.
To recycle items that are not packaging or paper, contact the Recycling Council of BC (RCBC) at 1-800-667-4321 or visit RCBC.ca.

Unused Medication

Empty medication containers can be recycled with Recycle BC, but unused or expired medications can be safely disposed by returning them to community pharmacies. For more information or to find the nearest pharmacy please visit www.healthsteward.ca.

FOAM PACKAGING (return to depot)

Foam meat trays (remove absorbent pad)

Foam take-out containers and cups

Foam cushion packaging used to protect electronics etc.

- ✗ Blue or pink foam insulation, packing chips and peanuts
- ✗ Squishy or flexible foam, foam noodles

PLASTIC BAGS AND OVERWRAP (return to depot)

Plastic bags

Outer bags and product wraps

- ✓ Bags for groceries, produce, dry bulk foods, frozen vegetables, water softener, salt, garden products, newspapers, etc.
- ✓ Overwrap for diapers, feminine hygiene products, paper towels, soft drink flats

NOT ACCEPTED
Do NOT place into Yellow Bag or Blue Box

Hard and soft cover books

Plastic bags and overwrap

Clothing and textiles

Food, yard waste and wood

- ✗ Non-paper gift wrap, foil wrap, cards or paper with glitter
- ✗ Rubber bands, ribbons, bows
- ✗ Padded envelopes
- ✗ Bags and boxes with foil liners
- ✗ Paper towels, napkins and tissues
- ✗ Foil or plastic lined paper bags

NO HAZARDOUS MATERIALS

Exclude batteries; medical sharps; bleach or aerosol containers with any contents remaining; compressed gas cylinders, for example used propane cylinders; containers for paint, motor oil, vehicle lubricants, or antifreeze; or containers for pesticides with the words DANGER, WARNING, or POISON, and precautionary octagon or diamond symbols with skull and cross bones.

NOT ACCEPTED
Do NOT place into Blue Box

Plastic bags and overwrap

Hazardous waste

Glass

Electronics and appliances

Toys and games

Hangers, pots, pans and other scrap metal

- ✗ Foam packaging
- ✗ Chip or foil bags, candy wrappers
- ✗ Stand-up pouches
- ✗ Packaging labeled biodegradable or compostable
- ✗ Wiring, metal cords, hardware
- ✗ Clothing, textiles and shoes
- ✗ Food and yard waste

Characteristics of Plastic Bags and Overwrap vs. Other Flexible Plastic Packaging

PLASTIC BAGS AND OVERWRAP

Can Poke Your Thumb Through It

Not Crinkly

Single Material

OTHER FLEXIBLE PLASTIC PACKAGING

Doesn't Stretch

Crinkly

Foil Lining

OTHER FLEXIBLE PLASTIC PACKAGING (return to depot)

Crinkly wrappers and bags

Flexible packaging with plastic seal

Zipper lock and stand-up pouches

Woven plastic bags

Non-food protective packaging

For more information, visit RecycleBC.ca/FlexiblePackaging

- ✗ Plastic squeeze tubes, plastic-lined paper, paper-lined plastic, plastic strapping
- ✗ 6-pack rings, biodegradable plastic, vinyl