

RECYCLING COLLECTION SCHEDULE

May 2018 - April 2019

Place paper, container and glass recycling out by:



7:00 am

Recycling Collection Questions?

Smithrite Disposal Ltd. is Recycle BC's curbside collection partner in Vancouver. They can answer questions about collection zones, missed pick-ups, holiday schedules, or recycling containers.

Contact Smithrite Disposal Ltd.
Phone: 604-282-7966
Email: recycle@smithrite.com

For information on City of Vancouver garbage or green bin collection services, please phone 3-1-1 or visit vancouver.ca.

MAY 2018						
SUN	MON	TUE	WED	THU	FRI	SAT
29	30	1	2	3	4	5
6	7	8	9	10	11	12
13	14	15	16	17	18	19
20	21	22	23	24	25	26
27	28	29	30	31	1	2

JUNE 2018						
SUN	MON	TUE	WED	THU	FRI	SAT
27	28	29	30	31	1	2
3	4	5	6	7	8	9
10	11	12	13	14	15	16
17	18	19	20	21	22	23
24	25	26	27	28	29	30

JULY 2018						
SUN	MON	TUE	WED	THU	FRI	SAT
1	2	3	4	5	6	7
8	9	10	11	12	13	14
15	16	17	18	19	20	21
22	23	24	25	26	27	28
29	30	31	1	2	3	4

AUGUST 2018						
SUN	MON	TUE	WED	THU	FRI	SAT
29	30	31	1	2	3	4
5	6	7	8	9	10	11
12	13	14	15	16	17	18
19	20	21	22	23	24	25
26	27	28	29	30	31	1

SEPTEMBER 2018						
SUN	MON	TUE	WED	THU	FRI	SAT
26	27	28	29	30	31	1
2	3	4	5	6	7	8
9	10	11	12	13	14	15
16	17	18	19	20	21	22
23	24	25	26	27	28	29

OCTOBER 2018						
SUN	MON	TUE	WED	THU	FRI	SAT
30	1	2	3	4	5	6
7	8	9	10	11	12	13
14	15	16	17	18	19	20
21	22	23	24	25	26	27
28	29	30	31	1	2	3

NOVEMBER 2018						
SUN	MON	TUE	WED	THU	FRI	SAT
28	29	30	31	1	2	3
4	5	6	7	8	9	10
11	12	13	14	15	16	17
18	19	20	21	22	23	24
25	26	27	28	29	30	1

DECEMBER 2018						
SUN	MON	TUE	WED	THU	FRI	SAT
25	26	27	28	29	30	1
2	3	4	5	6	7	8
9	10	11	12	13	14	15
16	17	18	19	20	21	22
23	24	25	26	27	28	29

JANUARY 2019						
SUN	MON	TUE	WED	THU	FRI	SAT
30	31	1	2	3	4	5
6	7	8	9	10	11	12
13	14	15	16	17	18	19
20	21	22	23	24	25	26
27	28	29	30	31	1	2

FEBRUARY 2019						
SUN	MON	TUE	WED	THU	FRI	SAT
27	28	29	30	31	1	2
3	4	5	6	7	8	9
10	11	12	13	14	15	16
17	18	19	20	21	22	23
24	25	26	27	28	1	2

MARCH 2019						
SUN	MON	TUE	WED	THU	FRI	SAT
24	25	26	27	28	1	2
3	4	5	6	7	8	9
10	11	12	13	14	15	16
17	18	19	20	21	22	23
24	25	26	27	28	29	30

APRIL 2019						
SUN	MON	TUE	WED	THU	FRI	SAT
31	1	2	3	4	5	6
7	8	9	10	11	12	13
14	15	16	17	18	19	20
21	22	23	24	25	26	27
28	29	30	1	2	3	4

DROP-OFF ONLY

TAKE TO RECYCLING DEPOT

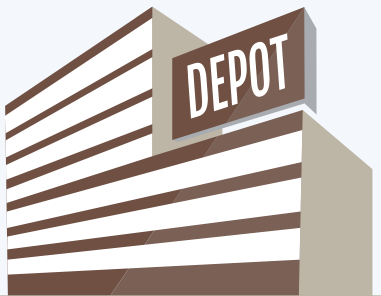

RECYCLEBC™

Making a difference together.

2018-2019
RECYCLING SCHEDULE

City of Vancouver

COLLECTION MAP

Check your address and collection schedule.
Download our app at RecycleBC.ca



Sign up for reminders, import your collection schedule into your on-line calendar, or download the Recycle BC app on your smartphone. Visit RecycleBC.ca for more information.

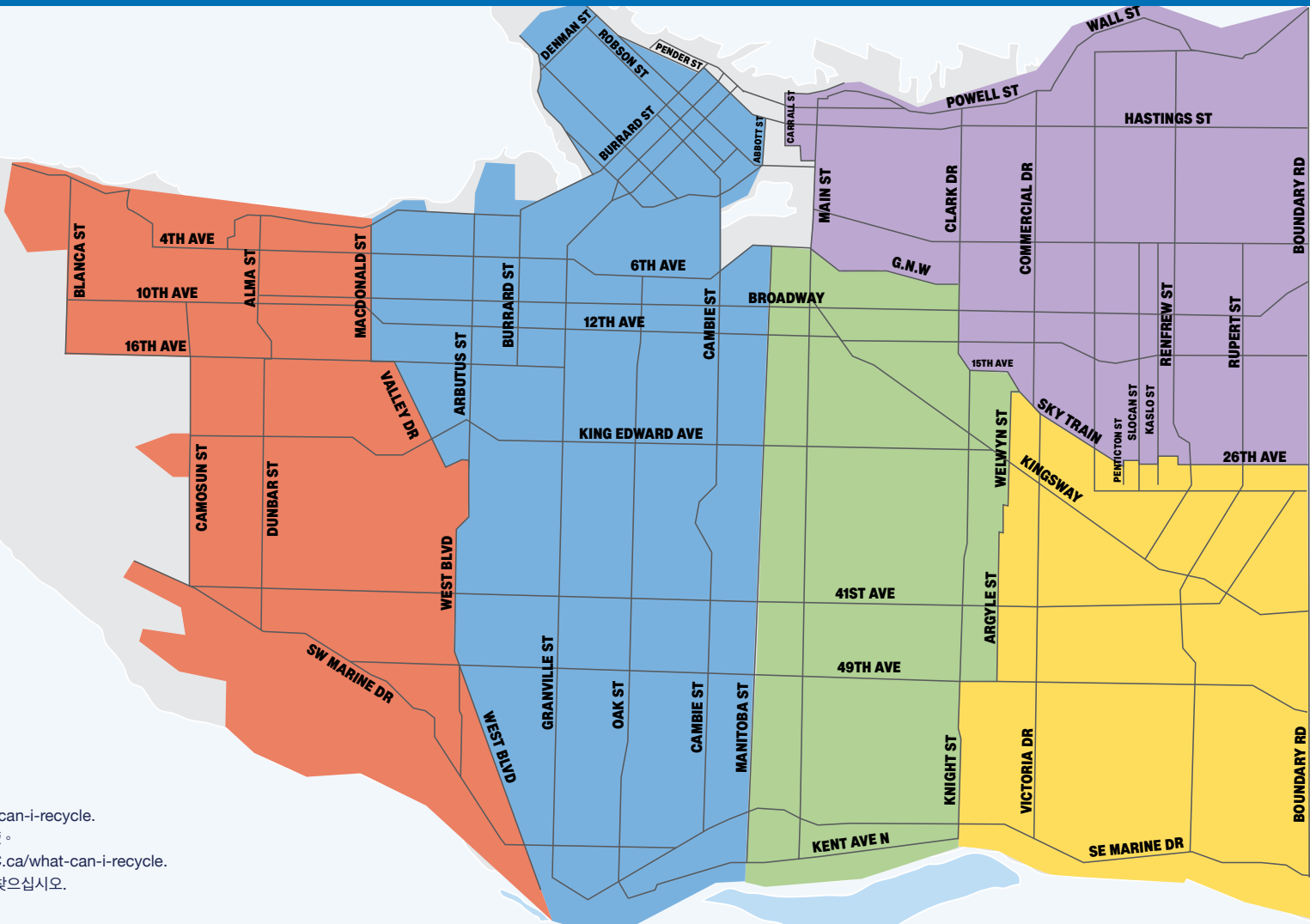

Please find a detailed material list at RecycleBC.ca/what-can-i-recycle.
請瀏覽 RecycleBC.ca/what-can-i-recycle 查詢物料清單中文版。
ਕਿਰਪਾ ਕਰਕੇ ਇਕ ਅਨੁਵਾਦਿਤ ਸਮੱਗਰੀ ਸੂਚੀ ਨੂੰ ਇਥੇ ਦੇਖੋ RecycleBC.ca/what-can-i-recycle.
번역 된 자료 목록은 RecycleBC.ca/what-can-i-recycle 에서 찾으십시오.

FOAM PACKAGING



Foam meat trays
(remove absorbent pad)



Foam take-out containers
and cups

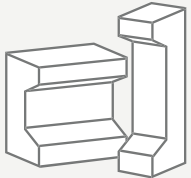

Foam cushion packaging used
to protect electronics etc.

PLASTIC BAGS AND OVERWRAP



Plastic bags

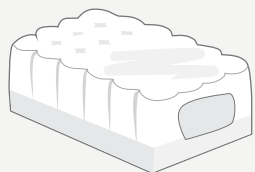

Outer bags and product wraps

- ✓ Bags for groceries, produce, dry bulk foods, frozen vegetables, water softener, salt, garden products, newspapers, etc.
- ✓ Overwrap for diapers, feminine hygiene products, paper towels, soft drink flats

- ✗ Blue or pink foam insulation, packing chips and peanuts
- ✗ Squishy or flexible foam, foam noodles
- ✗ Crinkly wrap for tea, floral arrangements etc.
- ✗ Pasta and cereal bags, chip and snack bags, stand-up pouches
- ✗ Zipper lock bags, garbage bags, kitchen stretch wrap
- ✗ Plastic shipping envelopes, bubble packaging

NEARBY DEPOTS

London Drugs (all Vancouver locations)
* accepting plastic bags, overwrap and foam packaging only

Powell Street Return-It Bottle Depot
1856 Powell Street, Vancouver
604-253-4987

South Van Bottle Depot
34 East 69th Avenue, Vancouver
604-325-3370

Vancouver Central Return-It Depot
2639 Kingsway Street, Vancouver
604-434-0707

Vancouver Zero Waste Centre
8588 Yukon Street, Vancouver
604-873-7000 or 3-1-1

Find your nearest depot location at:
RecycleBC.ca



RecycleBC.ca

PAPER

PUT INTO REUSABLE
RECYCLING BAG

Recycle at curbside or depot
Clean and dry paper only



CONTAINERS

PUT INTO BLUE BOX

Recycle at curbside or depot
Empty and rinse containers



GLASS

PUT INTO GREY BOX

Recycle at curbside or depot
Empty and rinse glass bottles and jars



RECYCLING TIPS

You can help ensure that more materials are recycled by following these steps:

- 1 Place your yellow bag between your grey box and your blue box, not across the top of them. Allow 1m (3 ft) between your recycling containers and your garbage and green bin.
- 2 Empty and rinse containers.
- 3 Contain shredded paper inside a paper bag or box before adding to your recycling.
- 4 Flatten cardboard, remove plastic wrap from cardboard flats. If too large for recycling container, flatten and cut to no larger than 30" wide (78 cm) by 30" tall (78 cm). Stack neatly and securely place beside or between recycling containers.

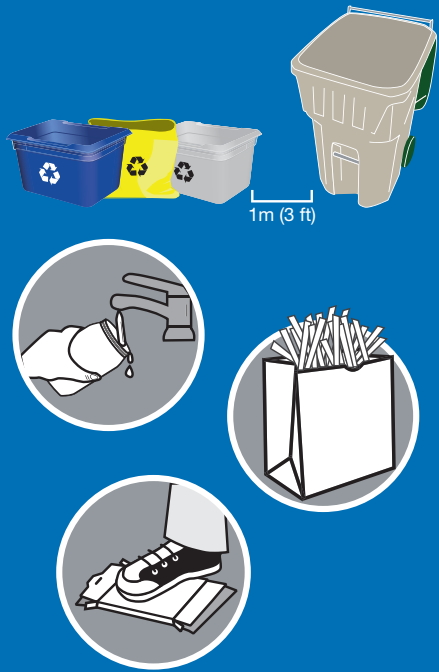

For more tips, visit [RecycleBC.ca](https://www.recyclebc.ca).

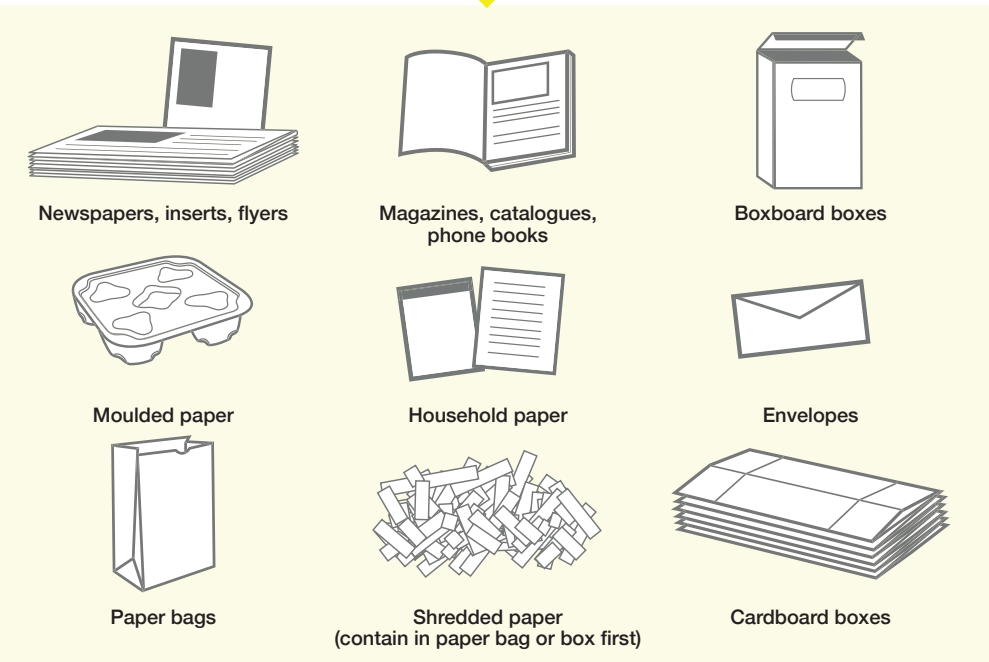

- ✓ Greeting cards
- ✓ Paper gift wrap
- ✓ Paper gift bags
- ✓ Paper carry-out beverage trays
- ✓ Cores from paper towel and toilet paper



- ✓ Plastic packaging for toys, batteries etc. Separate plastic from paper backing
- ✓ Plastic pails less than 25L for laundry detergent, cat litter etc.
- ✓ Spiral wound cans and lids for frozen juice concentrate, chips, etc.
- ✓ Plastic tubs for yogurt, margarine, etc.



Want to recycle something not included here?

Search Recycle BC's Waste Wizard or download a full material list at [RecycleBC.ca](https://www.recyclebc.ca).
To recycle items that are not packaging or printed paper, contact the Recycling Council of BC (RCBC) at 604-732-9253 or visit [RCBC.ca](https://www.rcbc.ca).

Unused Medication

Medicine containers can be recycled with Recycle BC, but unused or expired medication can be safely disposed through community pharmacies. For more information or to find a location nearest to you please visit www.healthsteward.ca.

RECYCLING COLLECTION QUESTIONS?

Smithrite Disposal Ltd. is Recycle BC's curbside collection partner in Vancouver. They can answer questions about collection zones, missed pick-ups, holiday schedules, or recycling containers.

Contact: Smithrite Disposal Ltd.
Phone: 604-282-7966
Email: recycle@smithrite.com

NOT ACCEPTED

Do NOT place into Yellow Bag



NO HAZARDOUS MATERIALS

Exclude batteries; medical sharps; bleach or aerosol containers with any contents remaining; compressed gas cylinders, for example used propane cylinders; containers for paint, motor oil, vehicle lubricants, or antifreeze; or containers for pesticides with the words DANGER, WARNING or POISON, and precautionary octagon or diamond symbols with skull and cross bones.

NOT ACCEPTED

Do NOT place into Blue Box



NOT ACCEPTED

Do NOT place into Grey Box



Return deposit containers for a refund.



ABOUT RECYCLE BC

Recycle BC is a non-profit organization responsible for residential packaging and paper products recycling throughout BC, servicing over 1.8 million households. Recycle BC ensures your household materials are picked up, sorted, and responsibly recycled. Our program is funded by over 1,200 businesses that include retailers, manufacturers and restaurants that supply packaging and paper products to BC residents, shifting costs away from homeowners.

For more information visit:
[RecycleBC.ca](https://www.recyclebc.ca)